

Now you can control power to your whole computer system or AV-system with a single click. The wireless remote switch lets you shut off power—including standby power—to up to six devices at once. Two Always-On Sockets stay on for devices that need continuous power, like your router or cordless phone. Place the remote on a desk or shelf, or mount it on the wall, for the convenient way to save energy. For more information and to learn about other Belkin Conserve energy management products, please go to [belkin.com/consERVE](http://belkin.com/consERVE)

**Package Contents**

- 8-Socket Conserve Switch Surge Protector
- Wireless Remote Switch (battery included)
- Remote Switch Wall-Mount
- User Guide and Warranty Information

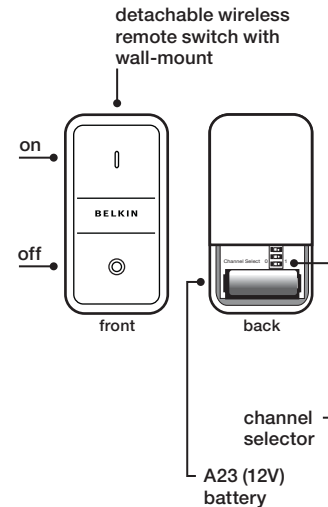
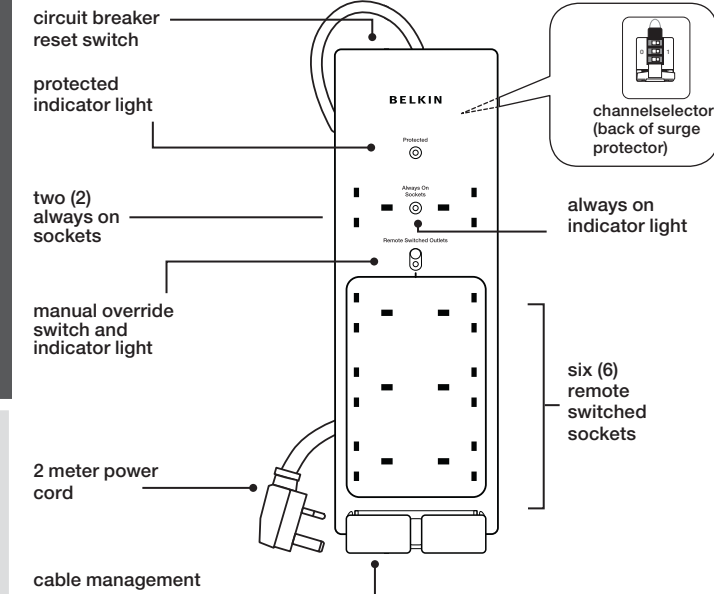

**QUICK SETUP GUIDE**

- 1 Plug in any of your devices that do not require constant, round-the-clock power into one of the Conserve Switch Surge Protector's Remote-Switched Sockets.
- 2 Plug in any of your devices that require constant, round-the-clock power into one of the Conserve Switch Surge Protector's Always-On Sockets.

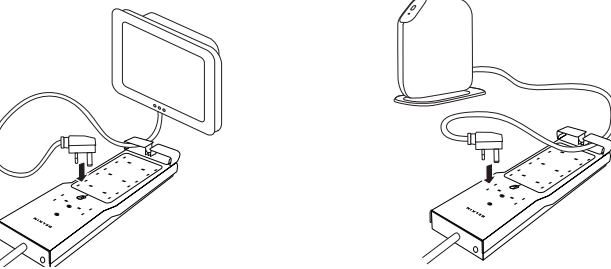

**INDICATOR LIGHTS**

- The "Always-On Sockets" light should be on if power is present. If this light goes out at any time, it means the circuit breaker has tripped and should be reset.
- The "Remote-Switched Sockets" light shows the state of the Remote-Switched Sockets. When the light is on, the Remote-Switched Sockets are powered; if the light is off, the Remote-Switched Sockets are not powered.

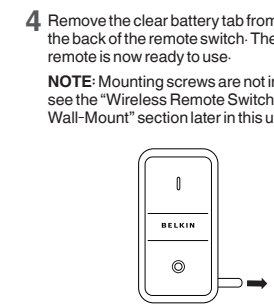

**HOW TO USE YOUR CONSERVE REMOTE SWITCH**

- 1 Firmly press and release the "I" button to turn ON the Remote-Switched Sockets. As you press the button, a green light flashes on the remote switch to indicate that the remote is working. Your devices are now powered and ready for use.
- 2 Turn on and use your devices as usual.
- 3 When you are finished using your devices, turn off each device as you normally would.
- 4 When your devices are turned off, firmly press and release the "O" button to turn OFF the Remote-Switched Sockets. As you press the button, a green light flashes on the remote switch to indicate that you have eliminated power to Conserve Switch's Remote-Switched Sockets. Devices plugged into the Always-On Sockets will remain powered.

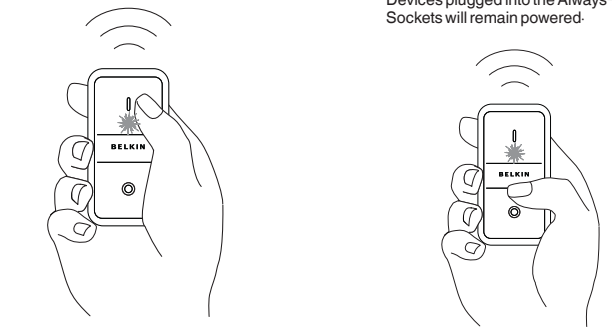

**SYNCING INSTRUCTIONS**

On the bottom left corner of the back of the Surge Protector, there is a similar set of switches. The switch settings on both the remote and Surge Protector must match in order for the remote to communicate with the Surge Protector. You can use a small screwdriver to shift the switches. By adjusting these channel setting switches, you can control multiple Conserve Switch Surge Protectors with a single remote switch. Adjust the channel setting on each Conserve Surge Protector to match the setting on a single remote switch. This will enable you to easily turn off the power to multiple devices connected to multiple surge protector units within range.\*

**SYNCING INSTRUCTIONS**

**Syncing your Conserve Switch Surge Protector and Wireless Remote Switch**  
By default your Conserve Switch Surge Protector and remote should be synced when purchased. However, if you need to change the sync settings for any reason, you can do this by locating and changing the channel setting switches on the back of the remote and on the back of the Surge Protector. On the back of the remote, under the battery cover, there is a series of three switches that can be set to up to eight different configurations.

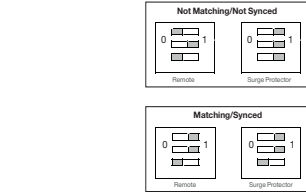

## PRODUCT FEATURES

- 2 Always-On Sockets
- 6 Remote-Switched Sockets (Switch ON and OFF in response to remote switch)
- Resettable circuit breaker
- "Always-On Sockets" light to show when power is present
- "Remote-Switched Sockets" light to show when switched Sockets are active
- Manual override button to control switched Sockets
- Conserve has a range of up to 20 meters.\* Line of sight from the wireless remote switch to the Surge Protector is not required.

- Cable-management system
  - Remote control to control multiple Conserve Switch Surge Protectors
- \*Actual range may vary depending on interference, building materials (e.g., masonry, metal walls), and other location-specific conditions.

## TROUBLESHOOTING

### My device won't turn on/off.

- Check whether the device is plugged into an Always-On Socket or a Remote-Switched Socket. If the device needs to stay on at all times, make sure it is plugged into one of the two Sockets labeled "Always On."
- Turn on/off the Remote-Switched Sockets using the wireless remote switch. Ensure the battery-life LED in the switch lights up. If it does not, replace the battery.
- Make sure the channel switch settings on the Surge Protector and the wireless remote switch match. See the "Installation, Mounting and Syncing Instructions" section.
- The Surge Protector may have been overloaded. Press the circuit-breaker button to reset the circuit.
- Turn on/off the Remote-Switched Sockets using the button on the surge unit.

## Replacing the battery

- Functional range may decrease as the battery wears out.
- Remove the battery cover from the back of the wireless remote switch.
- Replace the battery with an A23 (12V) alkaline battery.
- Please recycle or dispose of the battery responsibly. Recycling facilities may not be available in your area.

The manual override switch on the Surge Protector can also be used to turn the Remote-Switched Sockets on or off without the wireless remote switch in the event the remote is lost or the battery needs replacing.

The manual override switch on the Surge Protector can also be used to turn the Remote-Switched Sockets on or off without the wireless remote switch in the event the remote is lost or the battery needs replacing.

## Technical Specifications

8 Sockets : 6 Remote-Switched 2 Always-On  
Electrical Rating: 250V~/13A/50Hz/3250W  
Surge Protection: 1800 Joules  
Power Cable: 2m

This product complies with the essential requirements of the European Union R&TE Directive 1999/5/EC, the Low Voltage Directive 2006/95/EC, and the EMC Directive 2004/108/EC. A copy of the European Union CE marking "Declaration of Conformity" may be obtained at the website: [www.Belkin.Com/DOC](http://www.Belkin.Com/DOC)

Your Belkin product contains a battery. For replacement please replace with the same type and size. Dispose of old batteries through a recycling center according to your national regulations.

## Safety Information

- To reduce the risk of electrical shock, unplug the unit and allow it to cool before cleaning.
- Do not "daisy-chain" this product or use it with extension cords. The Belkin Conserve's power cord must be plugged directly into an AC power source to ensure proper surge protection.
- For indoor use and in dry locations only. Not for use with aquariums or other water-related products.

## Belkin International, Inc., Limited 2-Year Product Warranty

**What this warranty covers:**  
Belkin International, Inc. ("Belkin") warrants to the original purchaser of this Belkin product that the product shall be free of defects in design, assembly, material, or workmanship.

### What the period of coverage is

Belkin warrants the Belkin product for two years.

### What will we do to correct problems?

**Product Warranty:**  
Belkin will repair or replace, at its option, any defective product free of charge (except for shipping charges for the product). Belkin reserves the right to discontinue any of its products without notice, and disclaims any limited warranty to repair or replace any such discontinued products. In the event that Belkin is unable to repair or replace the product (for example, because it has been discontinued), Belkin will offer either a refund or a credit toward the purchase of another product from Belkin.com in an amount equal to the purchase price of the product as evidenced on the original purchase receipt as discounted by its natural use.

## What is not covered by this warranty?

All above warranties are null and void if the Belkin product is not provided to Belkin for inspection upon Belkin's request at the sole expense of the purchaser, or if Belkin determines that the Belkin product has been improperly installed, altered in any way, or tampered with. The Belkin Product Warranty does not protect against acts of God such as flood, lightning, earthquake, war, vandalism, theft, normal-use wear and tear, erosion, depletion, obsolescence, abuse, damage due to low voltage disturbances (i.e. brownouts or sags), non-authorized program, or system equipment modification or alteration.

THIS WARRANTY CONTAINS THE SOLE WARRANTY OF BELKIN. THERE ARE NO OTHER WARRANTIES, EXPRESSED OR, EXCEPT AS REQUIRED BY LAW, IMPLIED, INCLUDING THE IMPLIED WARRANTY OR CONDITION OF QUALITY, MERCHANTABILITY OR FITNESS FOR A PARTICULAR PURPOSE, AND SUCH IMPLIED WARRANTIES, IF ANY, ARE LIMITED IN DURATION TO THE TERM OF THIS WARRANTY.

IN NO EVENT SHALL BELKIN BE LIABLE FOR INCIDENTAL, SPECIAL, DIRECT, INDIRECT, CONSEQUENTIAL OR MULTIPLE DAMAGES SUCH AS, BUT NOT LIMITED TO, LOST BUSINESS OR PROFITS ARISING OUT OF THE SALE OR USE OF ANY BELKIN PRODUCT, EVEN IF ADVISED OF THE POSSIBILITY OF SUCH DAMAGES.

This warranty gives you specific legal rights, and you may also have other rights, which may vary from jurisdiction to jurisdiction. Some jurisdictions do not allow the exclusion or limitation of incidental, consequential, or other damages, so the above limitations may not apply to you.

## BELKIN

**Belkin Tech Support**  
<http://www.belkin.com/support>

For more information and to learn about other Belkin Conserve energy management products, please go to [belkin.com/conserve](http://belkin.com/conserve)

8820uk00555  
F7C01008

FCC ID: K7S-BG200001

FOR HOME OR OFFICE USE



## Use Energy Wisely

Using electricity or driving a car does have an effect on the environment, but by using energy wisely we can prevent waste and reduce carbon dioxide (CO<sub>2</sub>) emissions.

CO<sub>2</sub> is a greenhouse gas that accumulates in the Earth's atmosphere, trapping heat from the sun and keeping the planet warm. CO<sub>2</sub> comes, in part, from the burning of fossil fuels, such as coal and gasoline, to generate electricity for use in our homes and to power our cars.

The amount of CO<sub>2</sub> in our atmosphere has increased over the past century, and the majority of scientists questioned in a recent international study agree that global temperatures have risen dramatically compared with levels from the 1800s, with human activity being a significant contributing factor. According to the International Energy Agency, a warmer Earth may lead to changes in rainfall patterns, a rise in sea level, and a wide range of impacts on plants, wildlife, and humans.

A good way to visualize CO<sub>2</sub> is to imagine that 1 kg of CO<sub>2</sub> would fill up 1566 soda cans (0,35l), or a box 0,8m high, 0,8m wide and 0,8m deep.

Belkin Conserve products can help you do your part to use energy wisely.

**Use Less, Save More, Feel Good.**

Facts gathered from a study conducted by the University of Illinois, the International Energy Agency, and the U.S. Environmental Protection Agency.

# BELKIN

## Conserve Switch™ Surge Protector with Remote

## User Guide