

BELKIN®

Residential Gateway (RG) Battery Backup-REV B

Caution:

- Only install in a safe area that is free of obstructions that block the Unit's air vents and excessive dust.
- Screws must be appropriate for the total weight of the unit and the mounting surface material.

Wall-Mount Instructions

Required Tools and Materials:

- Drill Bit – Size is determined by the anchors or screw. Refer to the directions that came with your fasteners.
- 2 Anchors – Use appropriate type for your mounting surface. Anchors are required unless both screws are drilled directly into wood studs.
- 2 Screws – Use appropriate type for your anchor. Recommended size is #10, 2 ½" long.
- Drill and Screwdriver
- Level

Instructions:

1. Position this template on the wall where you want to mount the RG Battery Backup and use the level line to make sure the unit is parallel to the floor.
2. Mark the wall in the two screw locations indicated on this template. Remove the template from the wall.
3. Use a drill to drill holes where you made the mark on the wall. If you drill into a wall stud, proceed to step 5. Otherwise, continue on to step 4.
4. Insert anchor into the hole(s).
5. Screw in the screw, leaving a ¼" of the screw threads protruding from the wall.
6. Mount the RG Battery Backup on the screw.
7. Verify that the unit is securely attached to the wall.

Belkin Tech Support

US: 866-539-5791

www.belkin.com/gatewaybattery

Level Line

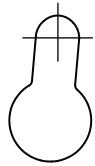

Drill Hole in These 2 Locations

