

## Car Installation

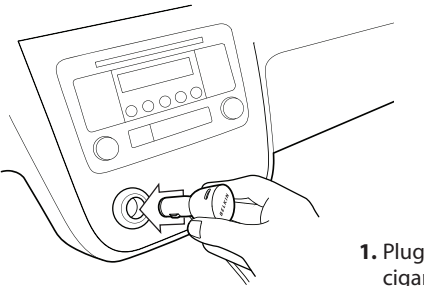

1. Plug adapter into car's cigarette-lighter outlet.

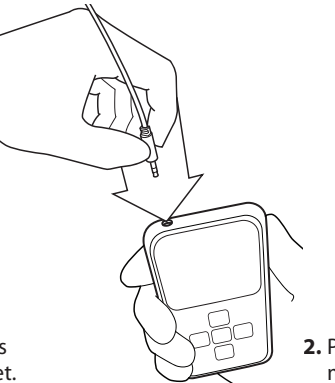

2. Plug headphone plug into media player's audio jack.

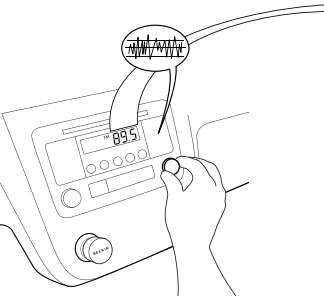

3. Find a frequency without a station on it. A good frequency will be between other stations, with a lot of static. To identify the best available frequencies in your area, visit [www.belkin.com/mybestfm](http://www.belkin.com/mybestfm).



4. Match station using up and down buttons.

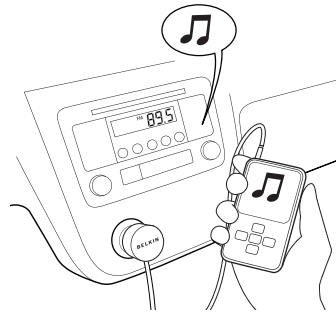

5. Play music.

## Storing Frequency (optional)

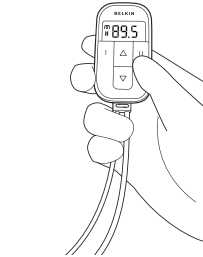

1. Press and hold the MI or MII button for two seconds to store station. When the MI or MII icon blinks, release the button.

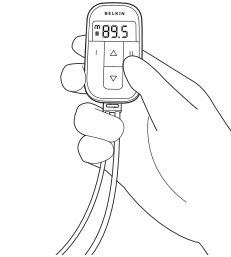

2. To recall a stored station, simply press the same MI or MII button.

**Start  
Here**

**TuneCast® Universal  
Quick Start Guide**

**BELKIN®**

[www.belkin.com](http://www.belkin.com)

**Belkin Tech Support**

US: 800-223-5546, ext. 2263

310-898-1100, ext. 2263

UK: 0845 607 77 87

Australia: 1800 235 546

New Zealand: 0800 235 546

Singapore: 65 64857620

Europe: [www.belkin.com/support](http://www.belkin.com/support)

© 2007 Belkin International, Inc. All rights reserved. All trade names are registered trademarks of respective manufacturers listed.

**BELKIN®**

P75614-A

F8M066